

Battery Warning LED:

LED OFF:

Battery 40% - 100%.

LED Slow Flash:

Battery 20% - 40%.

LED Medium Flash: Battery 10% - 20%.

LED Fast Flash: Battery below 10% - recharge immediately.

Charging:

To charge battery place the device in the cradle. Battery is charging when the charge LED is **RED**. Battery is fully charged when the charge LED is off.

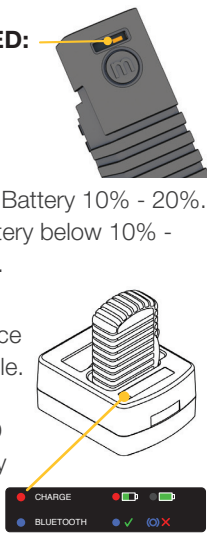

Battery/Power Management:

For power management of USB devices when PC is in sleep mode:

<https://www.top-password.com/blog/set-windows-to-power-on-off-usb-devices-in-sleep-mode/>

Battery and Tape Compartments:

1. Remove the silicone rubber sleeve.
2. Slide the back cover open and remove it.
3. Remove the tape cassette or battery.

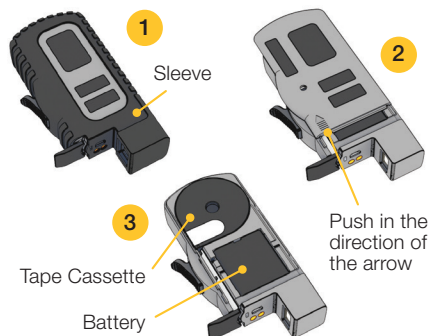

C190POS Quickstart Guide

VERSION 1.0.1

Register your device at www.cubetape.com/register

C190POS is a precision measuring instrument and barcode scanner with a wide range of configurable options including measurement units, precision and data formatting and will connect to most platforms including Windows Android and iOS. Cubetape scanner dimensioners have factory defaults set for common terminal, communication and measurement requirements. Settings can be changed by scanning the barcodes in this guide with further options available at www.cubetape.com/downloads

1. Power ON:

Hold down 'm' button for 2 seconds.

Power OFF:

Hold down 'm' button for 5 seconds.

2. Cradle Install on PC:

LED on cradle confirms power connection.

3. Connect Cubetape to Cradle:

Scan Cradle Pairing Barcode to pair.
Blue LED solid when connected.

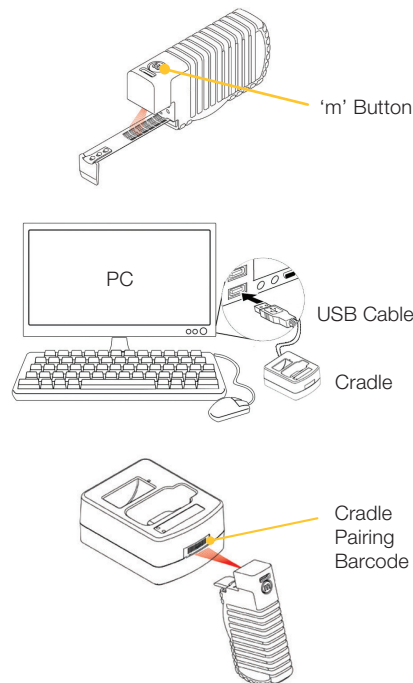

For full manual go to www.cubetape.com/downloads

For support email support@cubetape.com

Some features in this guide are unsupported in product with SN prior 201xxxx.



C190POS Quickstart Guide

VERSION 1.0.1

Register your device at www.cubetape.com/register

Measuring Techniques:

1. Hook the tape end over the far edge of the package.
2. Align the tape exit to the near edge.
3. Press the 'm' button to record and transmit the measurement.

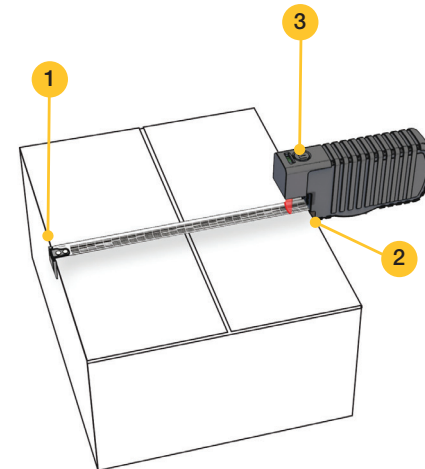

C190POS General Settings:



About



Suffix = TAB



Suffix = CR



Suffix = CRLF

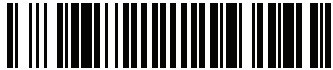

Default Factory Setting



Scan Engine Factory Setup

C190POS Quickstart Guide

VERSION 1.0.1

Register your device at www.cubetape.com/register



Connect directly to PC (without cradle):

Scan Bluetooth Direct Mode (HID) barcode.
Open PC Settings/Add Bluetooth Device/Select Cubetape.
When LED is solid **BLUE**, Cubetape is paired.



Connect directly to Android Device (without cradle):

Scan Bluetooth Direct Mode (HID) barcode.
Open Android Device Settings/Add Bluetooth Device/Select Cubetape.
When LED is solid **BLUE**, Cubetape is paired.



Bluetooth Direct Mode (HID)

Dip switches beneath cradle:



Default
Mode (HID)



Application
Mode (SPP)

Factory default settings are:

Setting	Factory Default
Bluetooth	Cradle Pairing Mode
Keyboard	English
Send Option	1DIM
Data Format	TAB
Source Prefix	OFF
Units	inches
Precision	nearest whole
Reverse Tare Value	112

C190POS User Shortcuts:

Automate data input with
shortcut barcodes.



Resend



Add/Append



Reverse Tare On



US Pallet 48 x 40



CHEP Pallet 117 x 117



UK Pallet 120 x 100



EURO Pallet 120 x 80

For full manual go to www.cubetape.com/downloads

For support email support@cubetape.com

Some features in this guide are unsupported in product with SN prior 201xxxx.