

C200 ScanStik Guide

How to use ScanStik March 2023



ScanStik is an adhesive label that lets you easily scan in dimensions of up to 2" (50mm), using a Cubetape device.



1. Peel the ScanStik and place it on an easily accessible reference edge - such as the side of the scale workbase.

The orange arrows should point towards the reference edge.

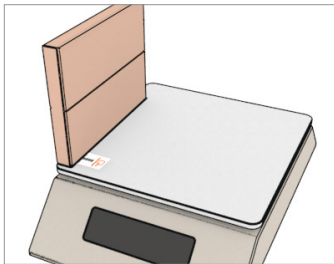

2. Place the package to be measured with its back edge next to the reference edge, and over the ScanStik.

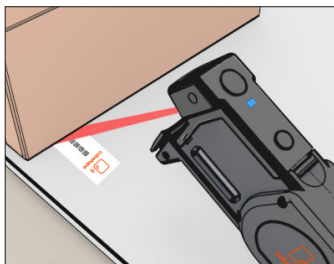

3. Use the Cubetape to scan the barcode on the ScanStik closest to the package. It may be easiest to scan down the package until the scanner reads the barcode on the ScanStik.