

C200 Series

Quickstart Guide April 2023

Scan Registration QR code or visit www.cubetape.com/register to register your device



IN THE BOX

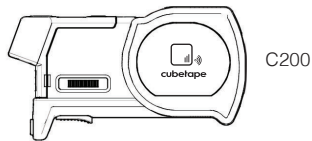

C200



USB Cable



RF Dongle

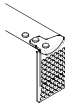

Bigfoot
Silicone Tip

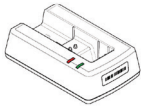

Charge Cradle
(if selected)



Quickstart Guide



ScanStik



ScanStik
User Guide



Shortcuts

Charge Cradle
also contains
the Shortcuts
Code on base.

For Scan to Pair and NFC pairing
options go to Configuration Guide.

For full manual go to

www.cubetape.com/support

For support email

support@cubetape.com



Registration



Pair



BT Direct (HID)



BT App (SPP)

CHARGE BATTERY: Insert USB cable by the Scan button and connect to adaptor or if using charge cradle, connect USB cable and insert C200. **Red LED** is **ON** when charging.

POWER ON C200: Press the Scan button to power on.

OPTION 1: Connect to Windows using RF dongle.

- Scan **Pair**, **LED** will flash **green**.
- Insert dongle in spare Windows USB port, **LED** will turn **blue** when connected.
- Dimensions and barcodes will now be sent to the active Windows app.

OPTION 2: Connect to Android or Windows using Bluetooth Direct Mode (HID).

- Scan **BT Direct (HID)**.
- Scan **Pair** or hold Scan button for 6 seconds to enter pairing mode.
LED will flash alternately **blue** and **green**. (To cancel pairing mode press Scan twice).
- Connect Cubetape from Android or Windows connection menu.
LED will turn **blue** when connected.
- Dimensions and barcodes will now be sent to the active app.

OPTION 3: Connect to 3rd Party Android or Windows app
using Bluetooth Application Mode (SPP).

- Scan **BT App (SPP)**.
- Refer to 3rd Party Application Guide.



Wireless Defaults

DEFAULTS AND FACTORY RESET

Factory default settings are:

Connect to Windows host using dongle

Units = inches Suffix DIM = TAB

Output = nearest inch Suffix GEN = TAB

Return to factory settings anytime by scanning

Scanner Defaults and **Wireless Defaults**.



Scanner Defaults

C200 Series

Quickstart Guide April 2023

Scan Registration QR code or visit www.cubetape.com/register to register your device



HOW TO MEASURE

1. Hook the tape end over the far edge of the package.
2. Align the tape exit point to the near edge of the package.
3. Press the Scan button to record and transmit the measurement.

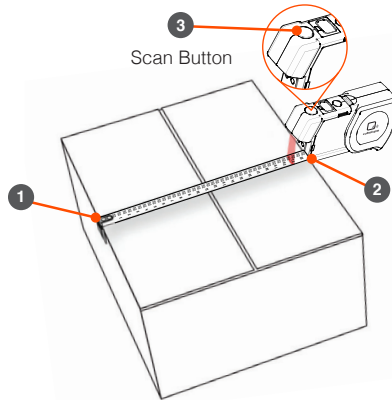

ASSEMBLY

1. The tape cassette has guide rails on both sides.
2. The C200 Pod has guide grooves on both sides.
3. Spring latch locks into the tape cassette.
4. Align grooves and rails.
5. C200 Pod slides down into the tape cassette.
6. The latch in the C200 Pod locks into the tape cassette.

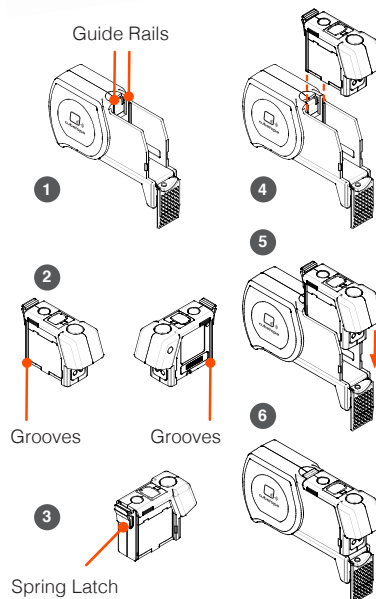

SET UNITS AND OUTPUTS

Select preferred units - inches or cm and output.



Units in



Output 0.5



Units cm



Output Nearest 1



Output Next 1

SET SUFFIX

Select preferred suffix for use with Dimensional (DIM) and General (GEN) items.



Suffix Dim CR



Suffix Gen CR



Suffix Dim TAB



Suffix Gen TAB